

The logo for the Virginia Department of Transportation (VDOT). It features a stylized orange 'V' shape on the left, followed by the letters 'VDOT' in a bold, blue, sans-serif font. The background is white with a blue and orange curved graphic on the left side.

VDOT

Gilmerton Bridge Replacement

Traffic Management During Construction

Rick Correa, P.E.
Hampton Roads District

November 19, 2008

- Project Overview
- Sequence of Construction / Maintenance of Traffic (SOC/MOT)
- Traffic Conditions (Existing and During Construction)
- Traffic Mitigation Strategies

Existing Gilmerton Bridge



Project Location

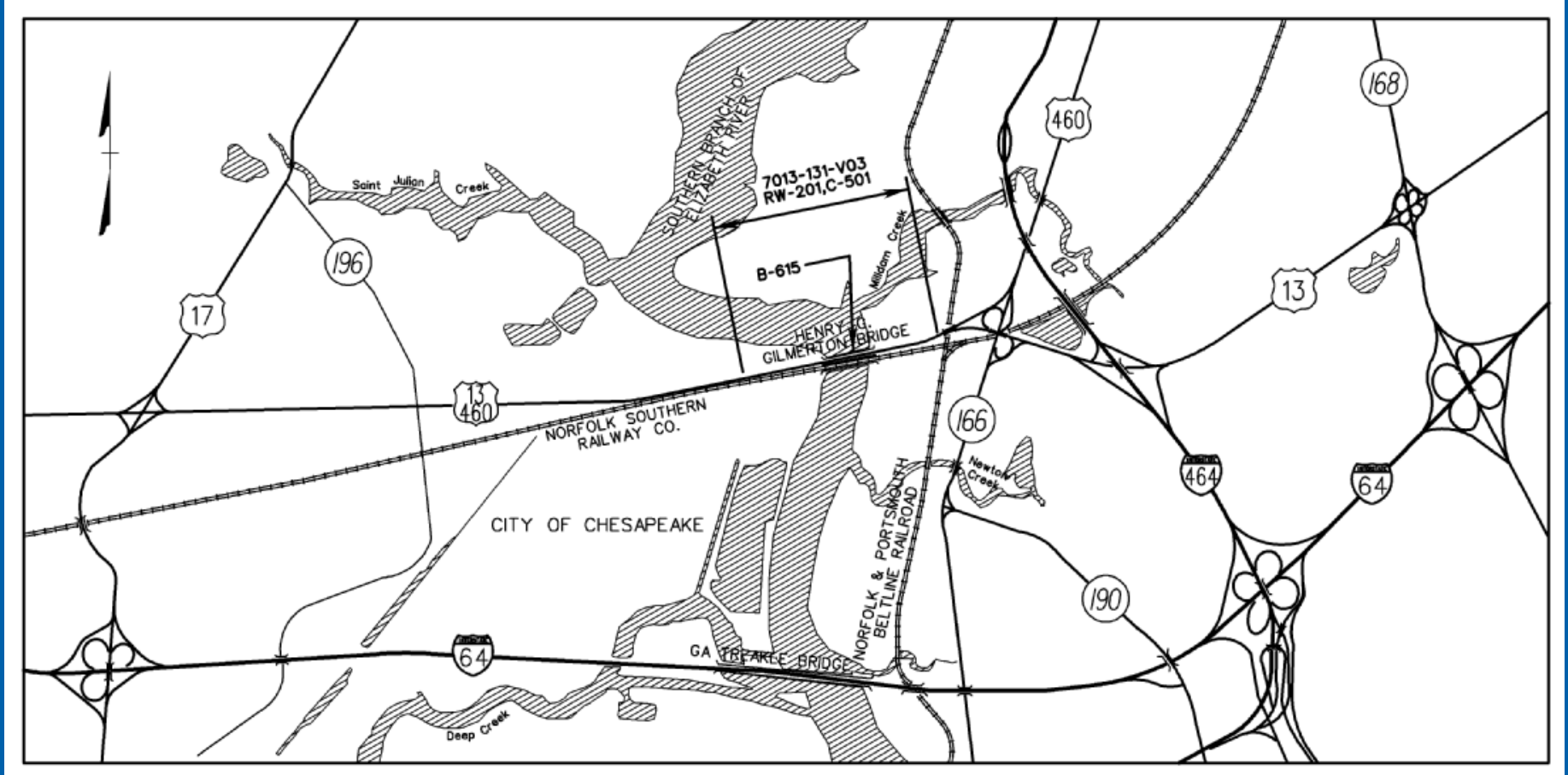

Proposed Gilmerton Bridge

- Proposed 4 lanes of traffic.
- Bridge can accommodate 6 lanes of traffic in future.

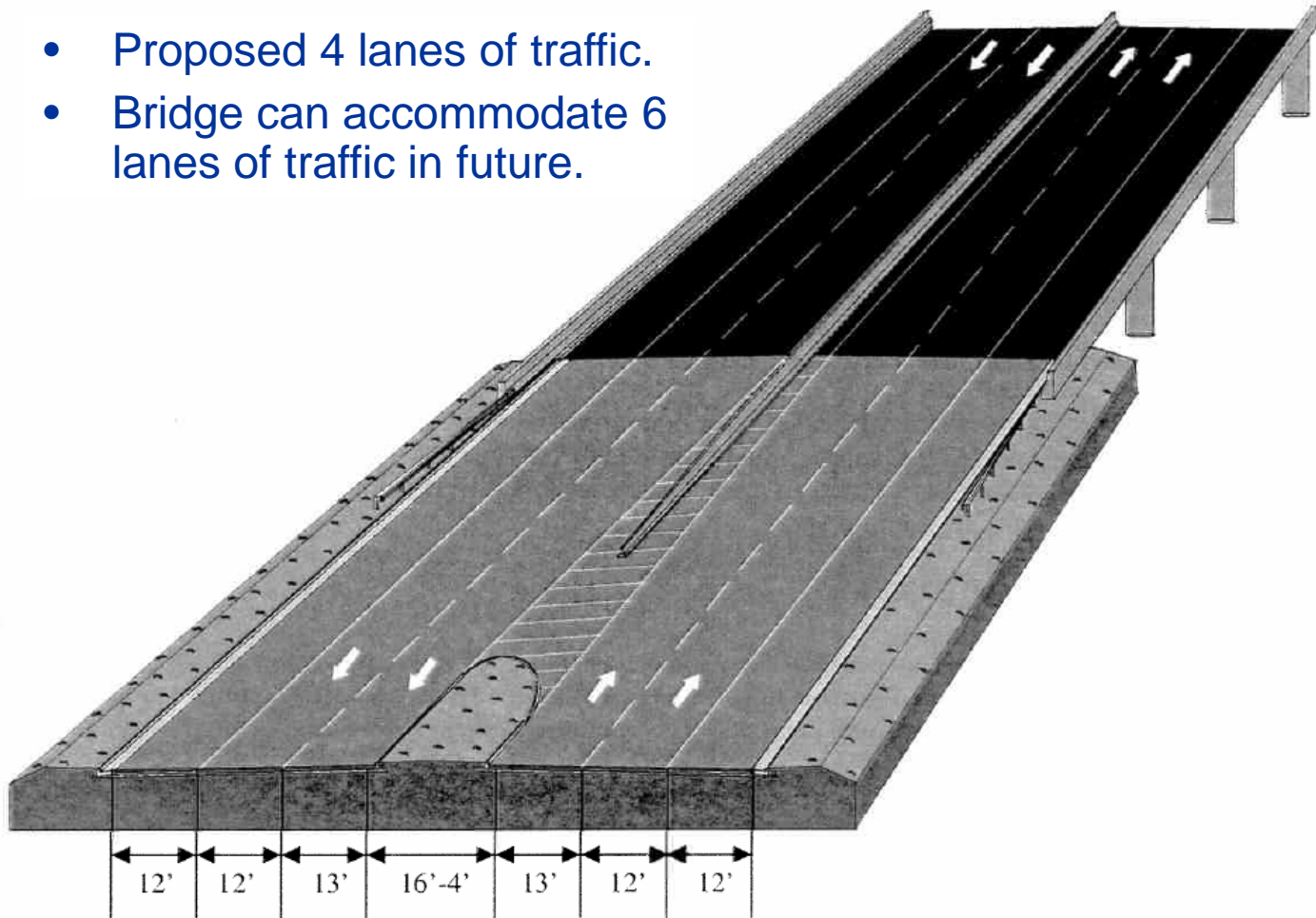

Proposed Gilmerton Lift Span

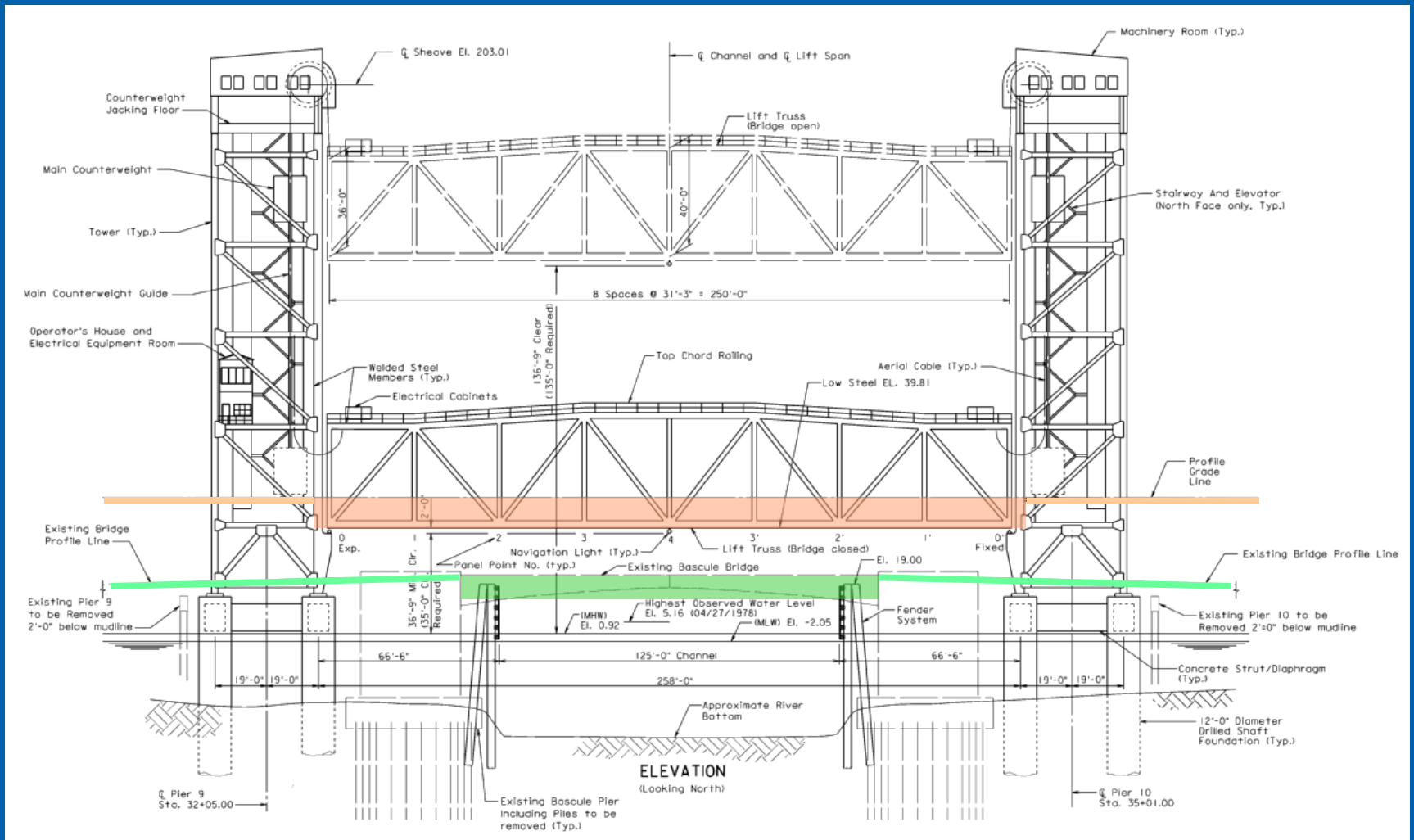

Proposed Gilmerton Lift Span

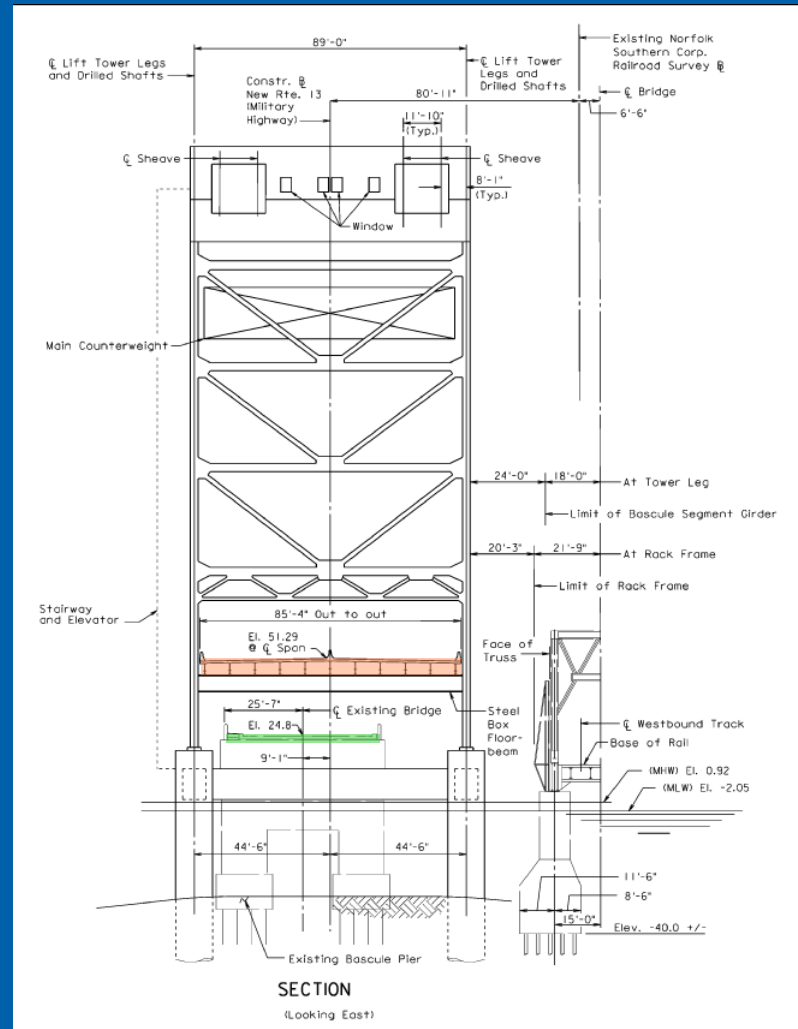

- Red – Proposed bridge deck.
- Green – Existing bridge deck.
- New tower foundations will straddle existing bridge section.

General Plan of Entire Project

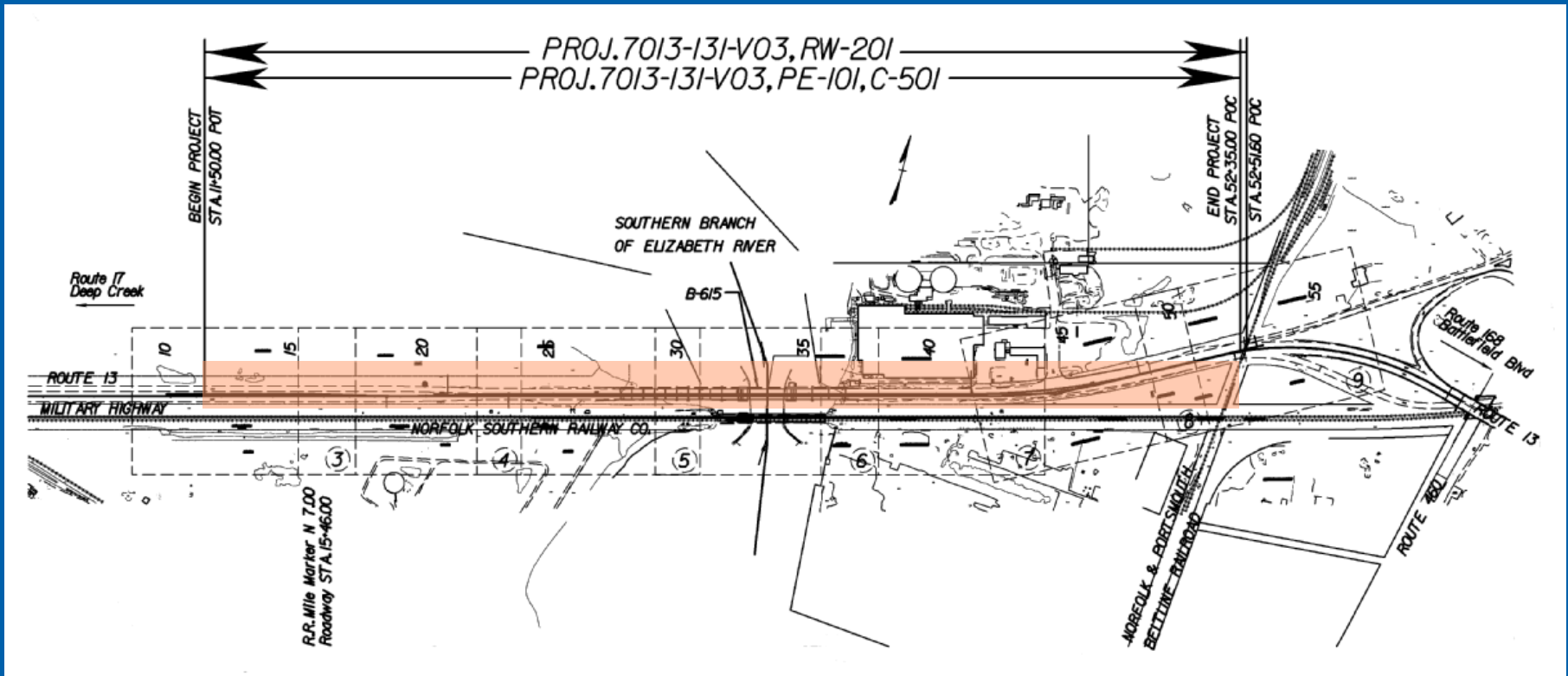

Stage I – 26 Months

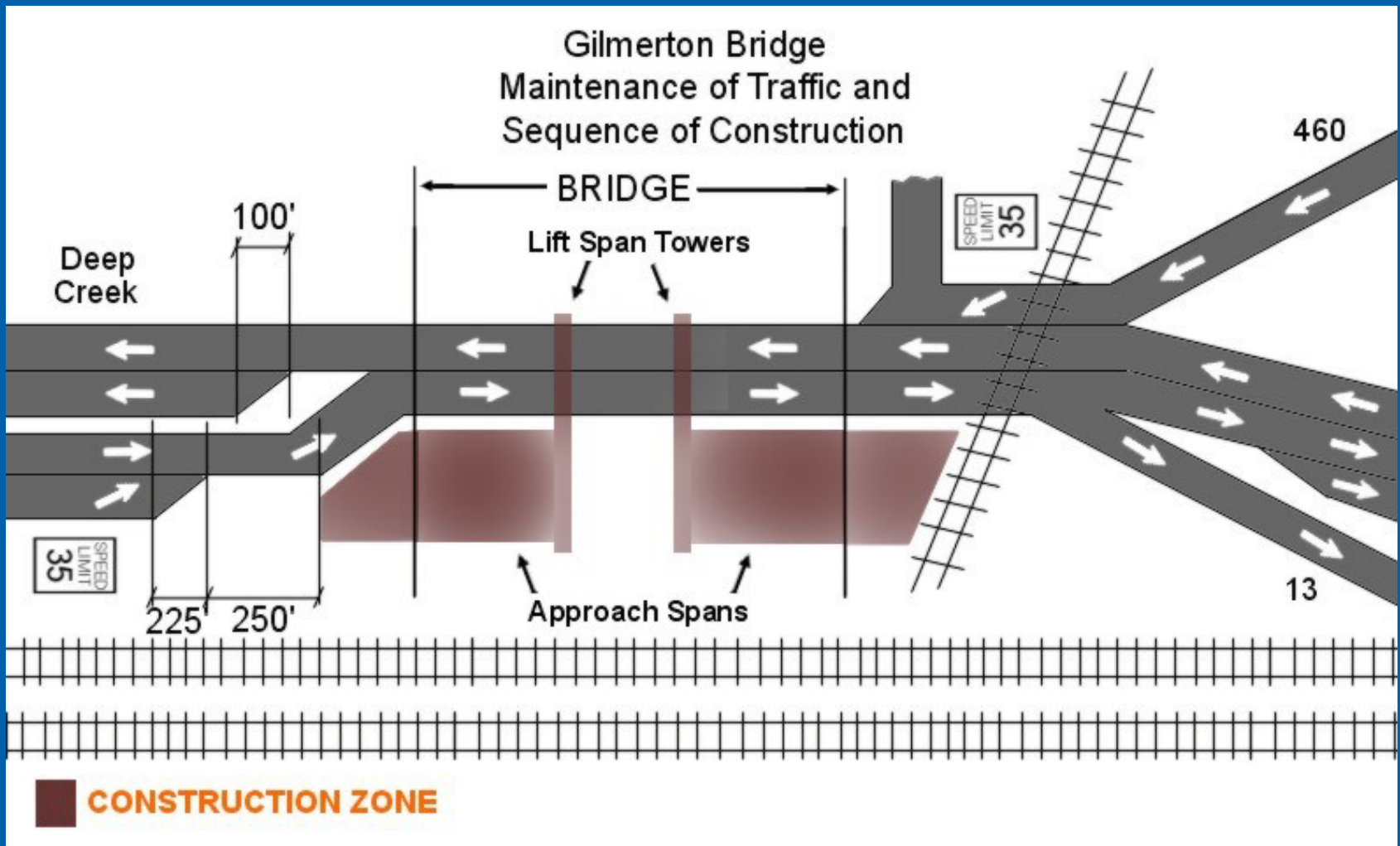

Stage II – 14 Days

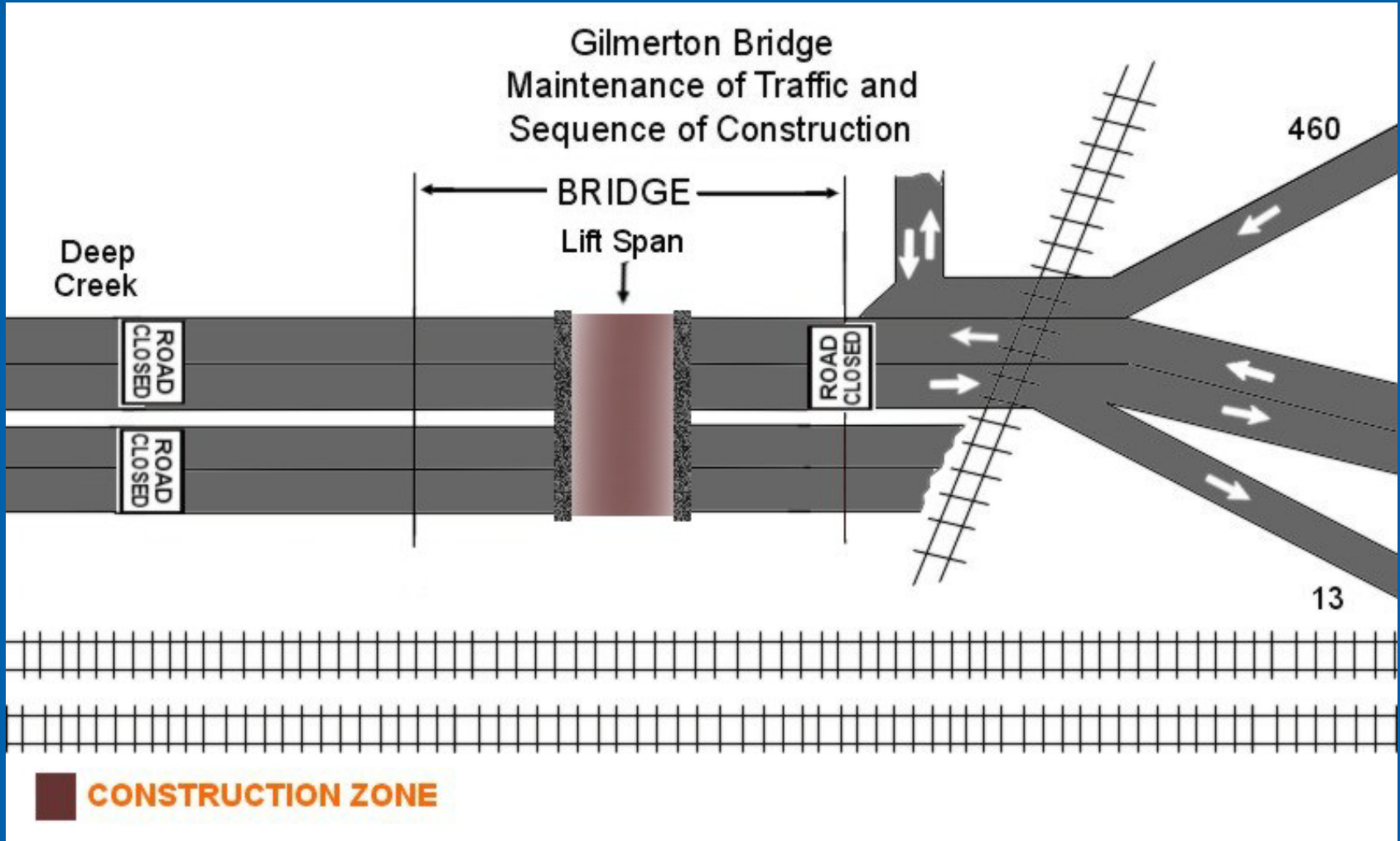

Stage II – Detour Plan

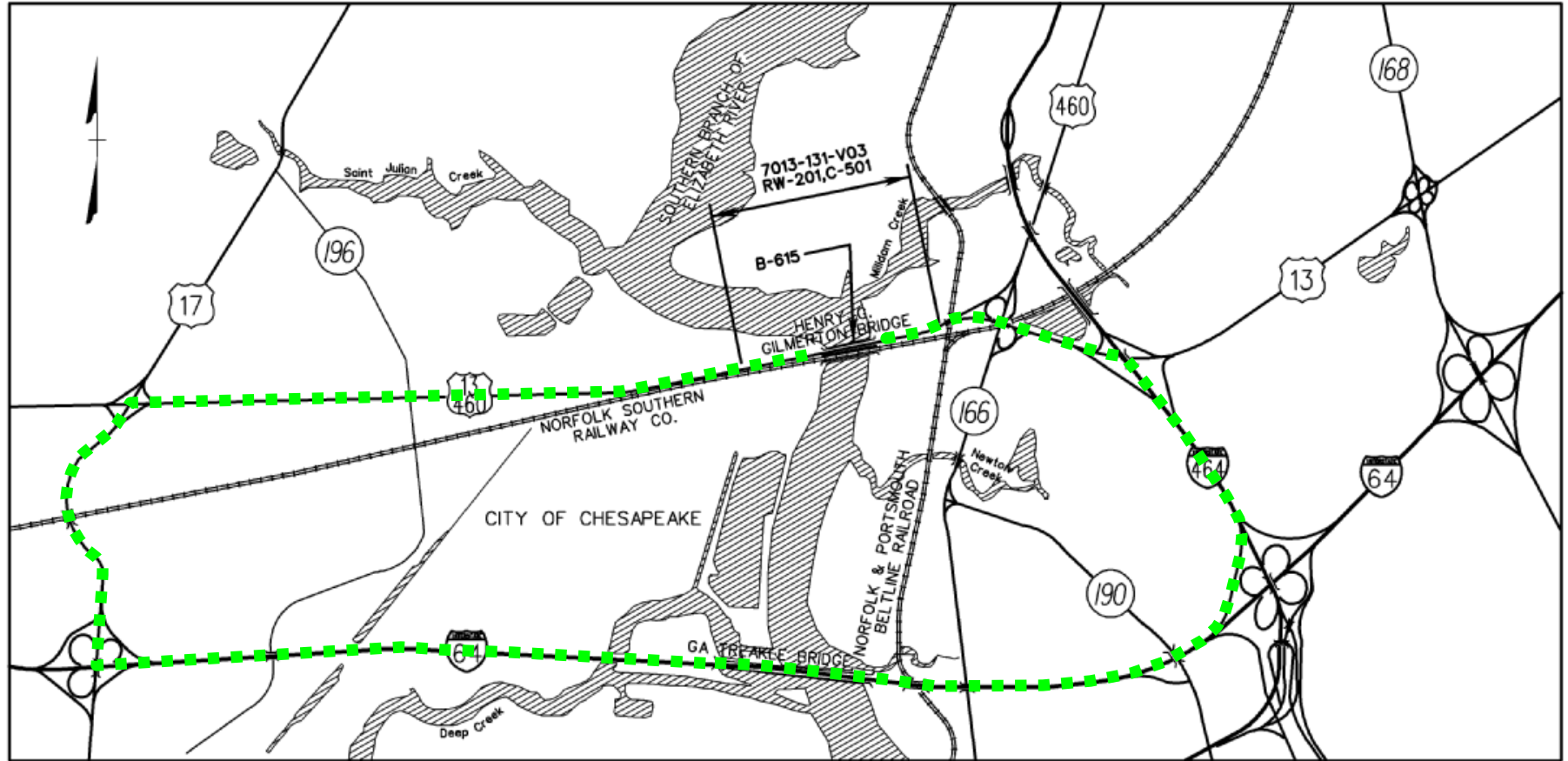

Stage II – Lift Span Float-In

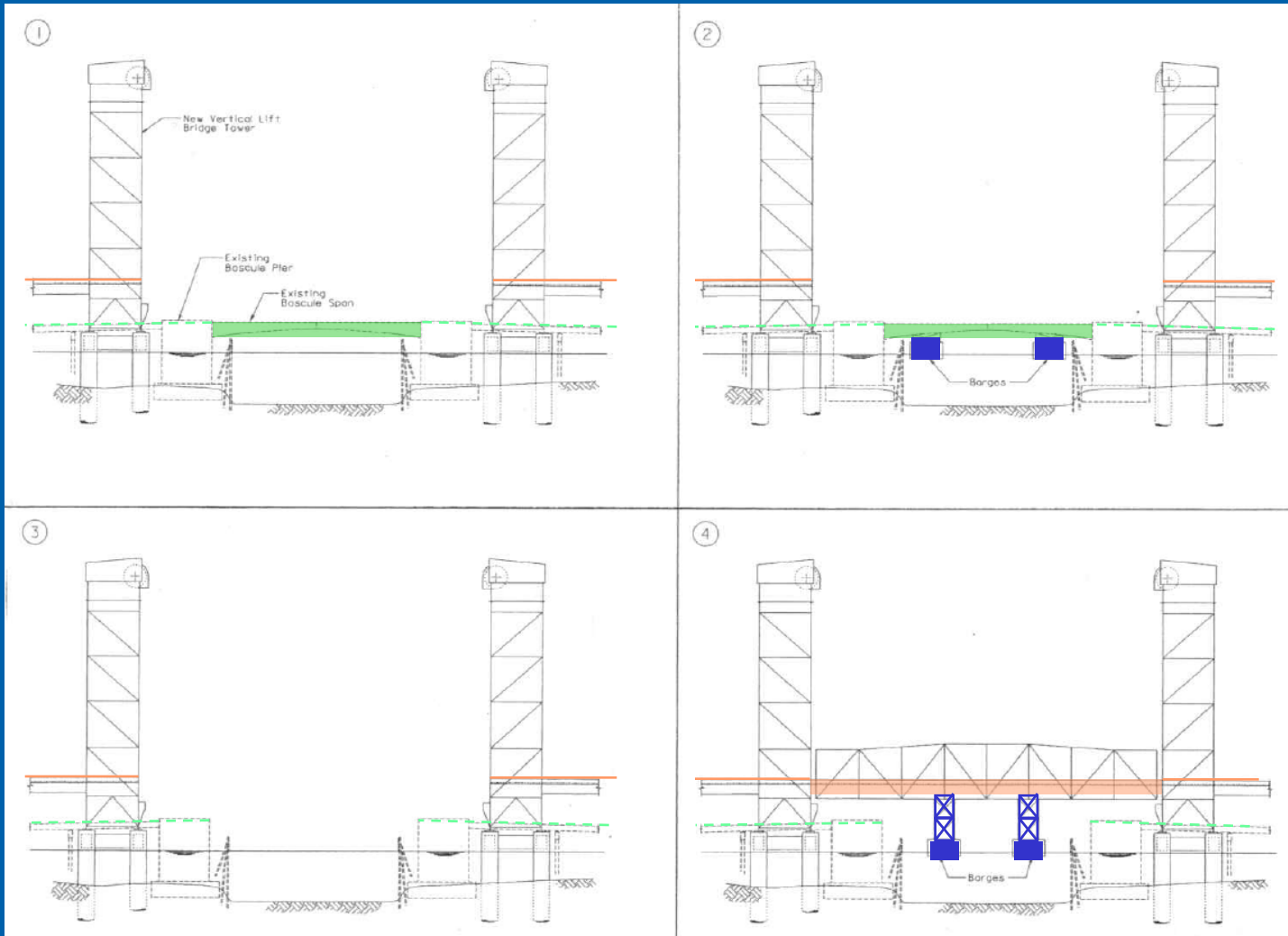

Stage III – 17 Months

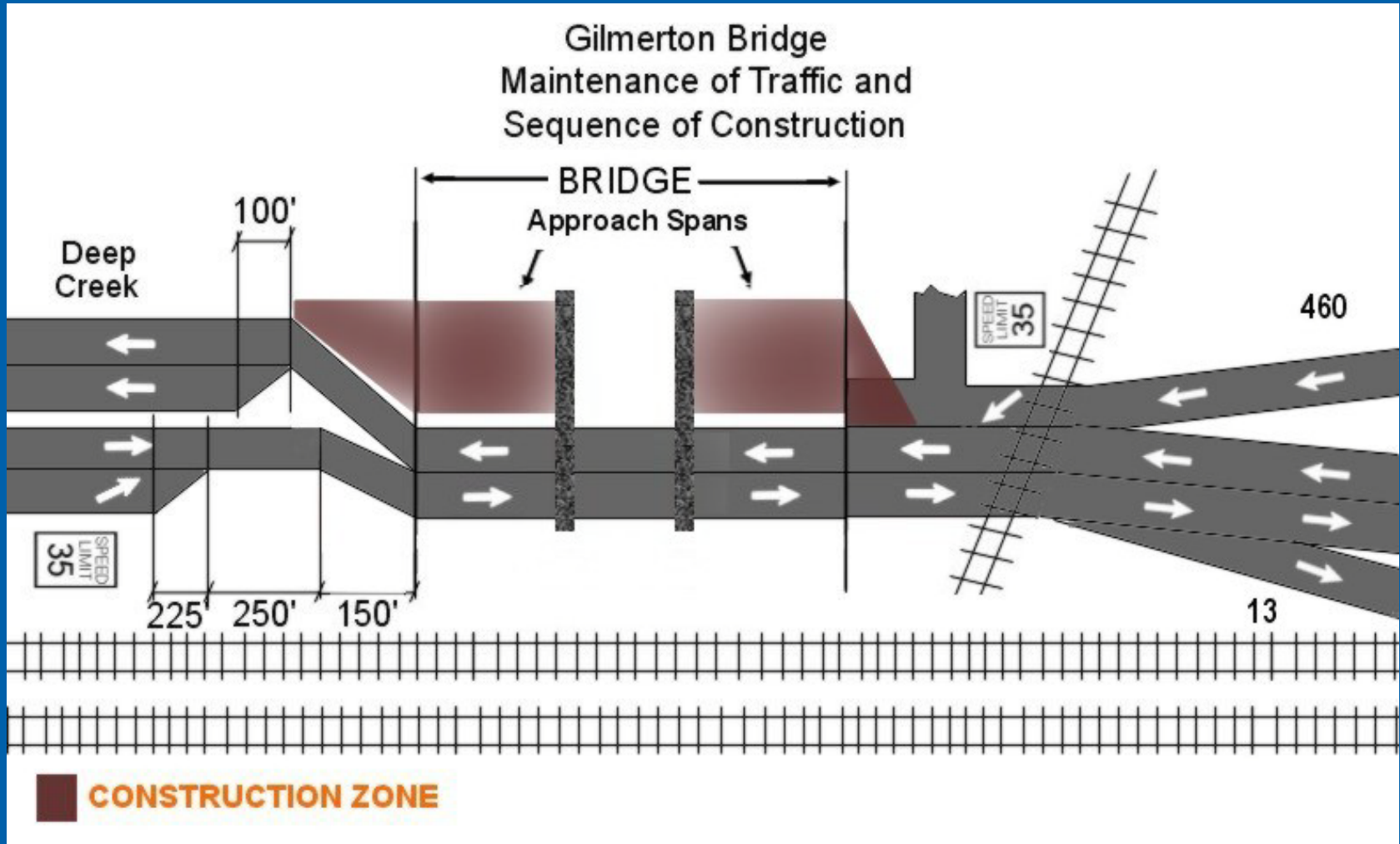

Stage IV – 6 Months

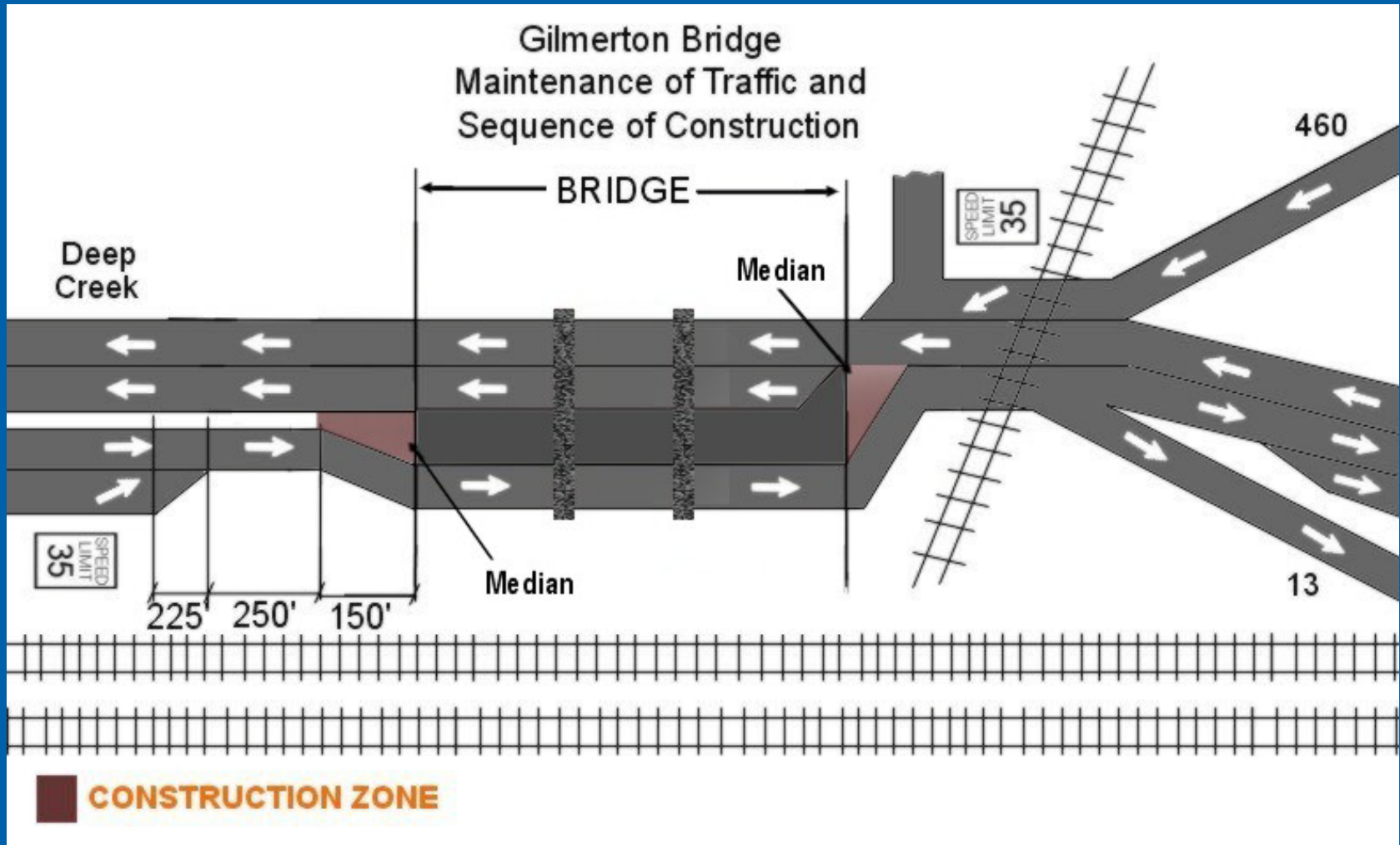

Diversion Analysis For Reduction From 4 to 2 Lanes:

- Traffic analysis performed by HRPDC in May 2008.
 - Verify maintenance of traffic impacts.
 - Did not include effects of the Jordan Bridge closure.
- Project design completed and approved by FHWA during September 2008.
- Second analysis by HRPDC performed in September 2008 to consider the effects of the Jordan Bridge closure.

Duplicate and Improve our Success at I-64 / Battlefield Boulevard:

- Detailed Sequence of Construction
- Detailed Maintenance of Traffic
- Proactive Public Information Plan
- Evolving Transportation Operations Plan
- Construction Incentives / Disincentives
- On-site Wrecker Service
- Construction Oversight Consultant (includes traffic experts)
- Partnership Among Key Stakeholders (Contractor, City, VDOT, Businesses)

Modifications to Bridge Opening Schedule

Current Restrictions to Bridge Openings

- 6:30 to 8:30 AM
- 3:30 to 5:30 PM

Extended Restrictions to Bridge Openings

- 6:30 to 9:30 AM
- 3:30 to 6:30 PM
- Extra hour would allow for traffic clearing.

City to submit a formal request to Coast Guard hopefully with written endorsements from VDOT and MPO.

Questions?

